

High Performance EHU and Coax Choke Jumper

- SteppIR is now using a new balun design which requires an external 1:1 choke, both are shown below. Antennas without relay switching will require a SO-239, UHF female to female coupler to attach to your main feedline (included with new antenna purchases).

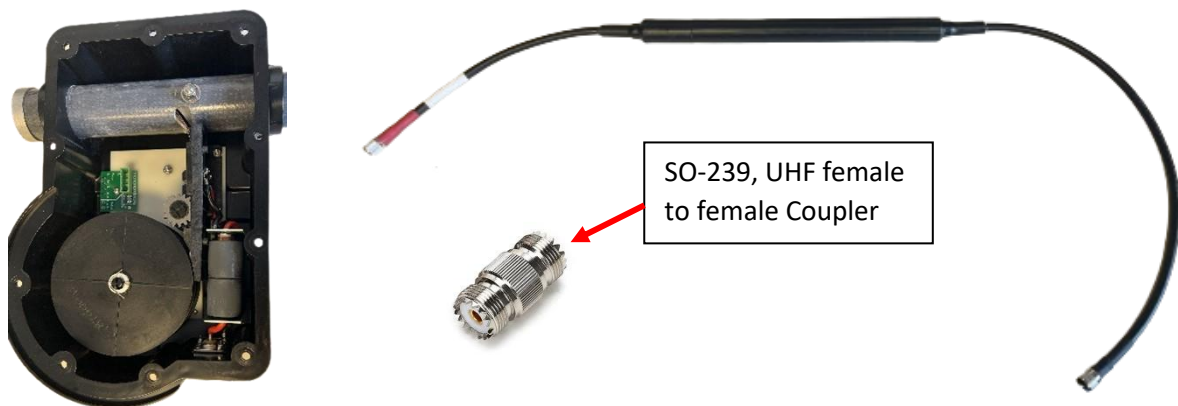

- When routing the new coax choke jumper be mindful of the bending radius/slack of the coax cable. Do not bend it too tight otherwise you will damage the coax choke jumper, EHU SO-239 connector, or EHU shell.
- Please note that the choke is made with ferrite cores and is fragile.
- Remember to tighten the PL259 connector with pliers and to seal any connections with coax seal, silicone tape, or another suitable sealant.
- The Coax Choke Jumper is labeled to show which side of the jumper goes to the EHU. This is to keep the 1:1 choke as close as possible to the EHU while still allowing different attachment methods.

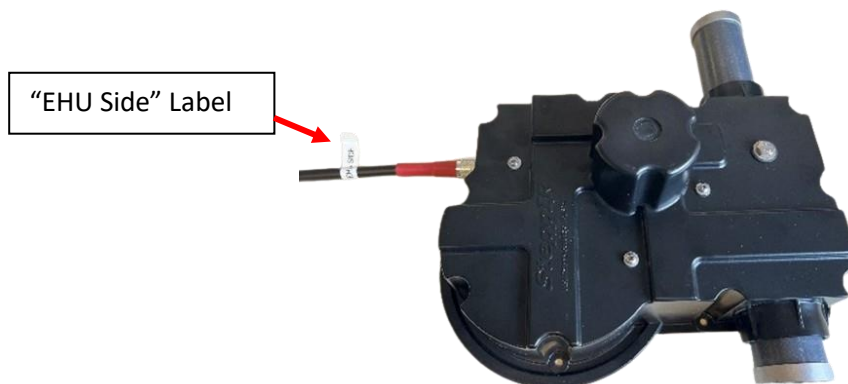

DB Mounting Plate antennas

- Attach the choke to aluminum saddle clamps or to the boom using UV resistant cable ties and electrical tape. Shown below are different attachment methods.

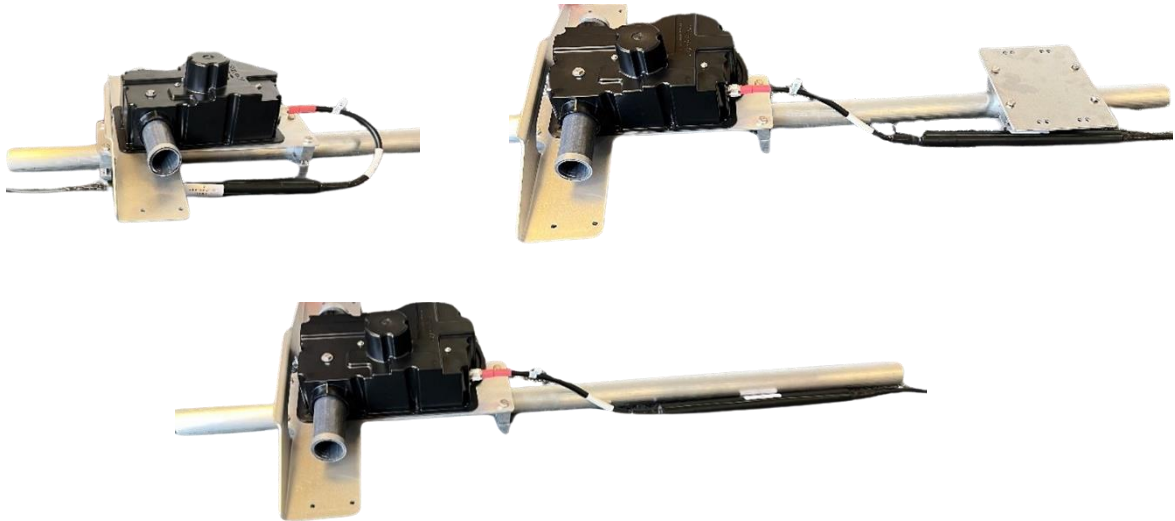

Legacy antennas (2E/3E/4E)

- Attach choke to aluminum boom using UV resistant cable ties and electrical tape. Shown below are different attachment methods.

